



VF Tripod User Manual

ZHONGSHAN JINGGE ELECTRONIC TECHNOLOGY CO., LTD.

UNC

Key Features

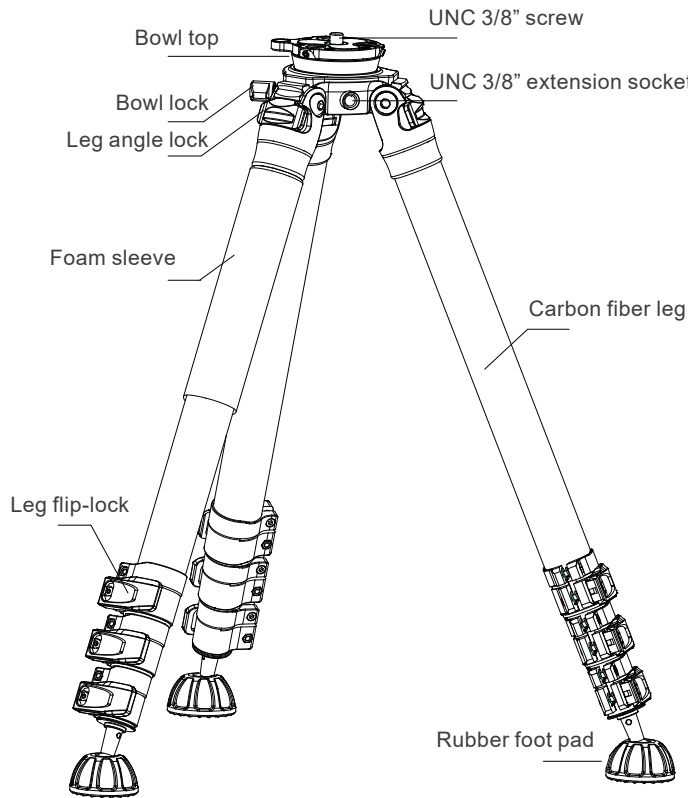

Bowl Top Angle Adjustment

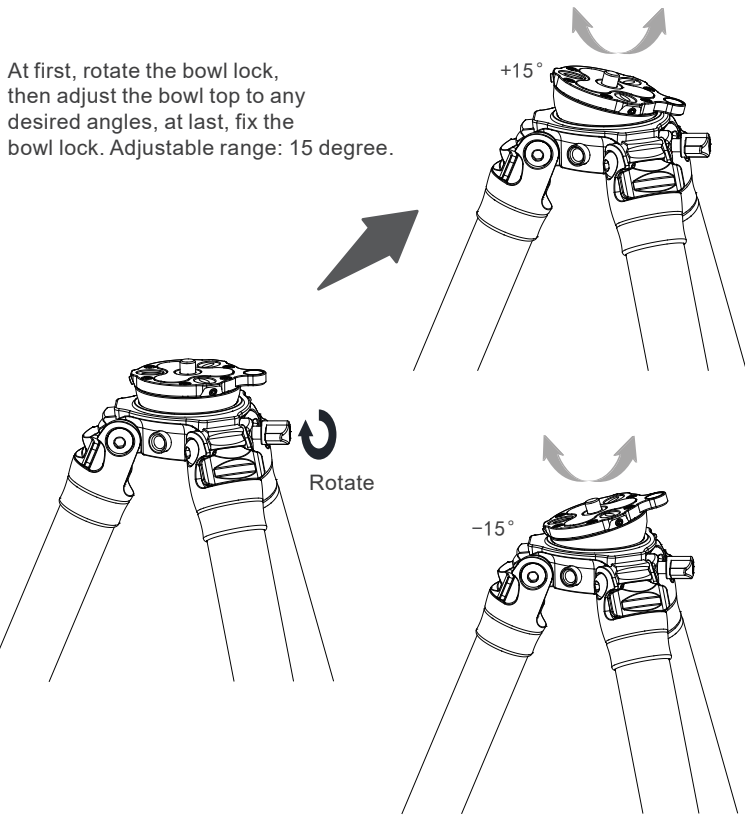

Leg Angle Adjustment

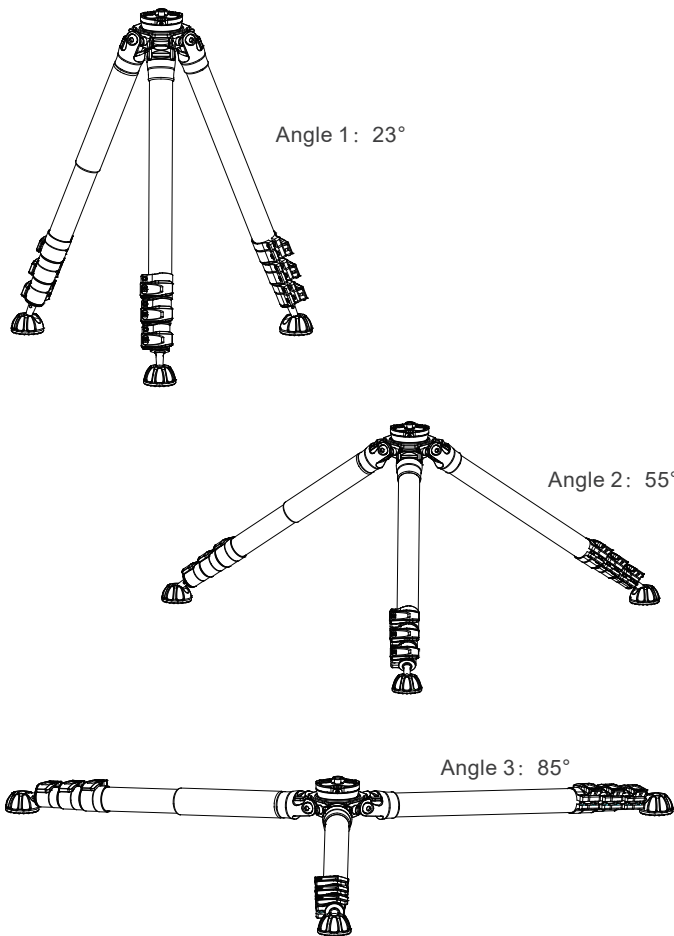
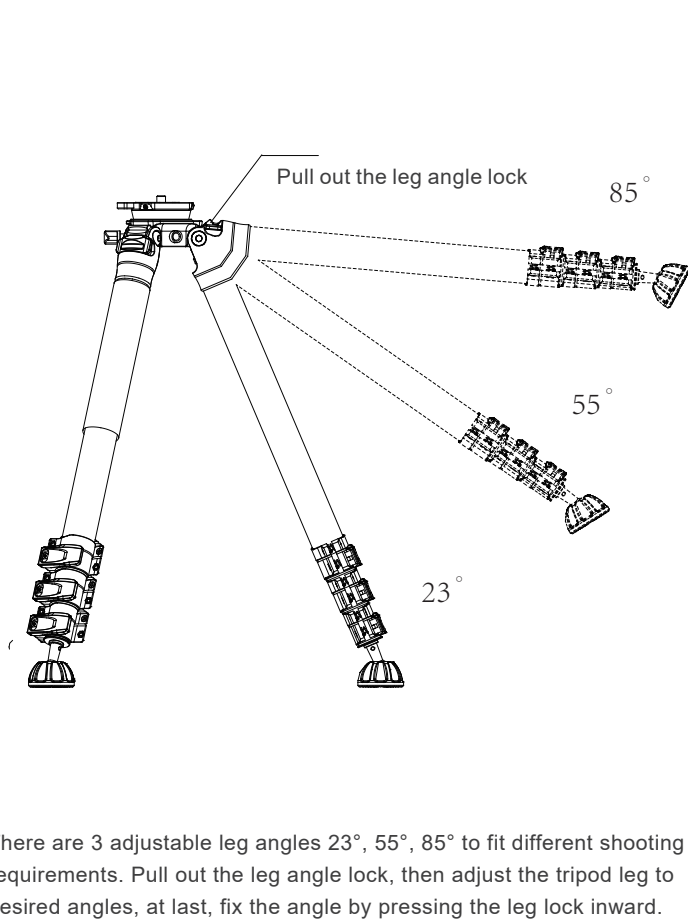

Notice

- 1.Do not exceed the specified load capacity.
- 2.Make sure to lock and keep safe when operating the tripod.
- 3.Do not use a tripod when the temperature is lower than minus 40 degrees or higher than 100 degrees.
- 4.Please clean the tripod when it is getting dirty or wet, do not use it in the sea.
- 5.Do not expose product under direct sunshine or high temperature for a long time.
- 6.Make sure all devices (e.g. cameras) were taken down from the tripod before transportation.
- 7.Keep the tripod and all accessories clean before packing for storage.
- 8.Unless necessary, the equipment does not need to be lubricated regularly. Please use the standard lube only if needed.
- 9.To ensure safety, do not connect the tripod with any power supply.



Tips

Please remove camera from the tripod before moving the tripod to other locations for shooting to avoid any damage to the camera, as violent shaking may break the camera screw thus break the camera, especially the camera with telephoto lens.
Extend the tripod legs in the order of from max tube to min tube, while fold the legs in the order of from min tube to max tube.

Spread Tripod

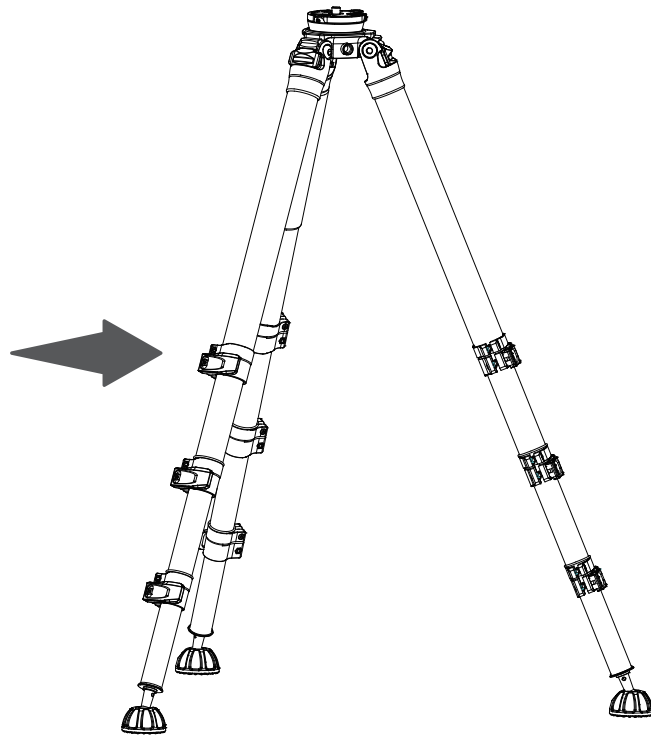
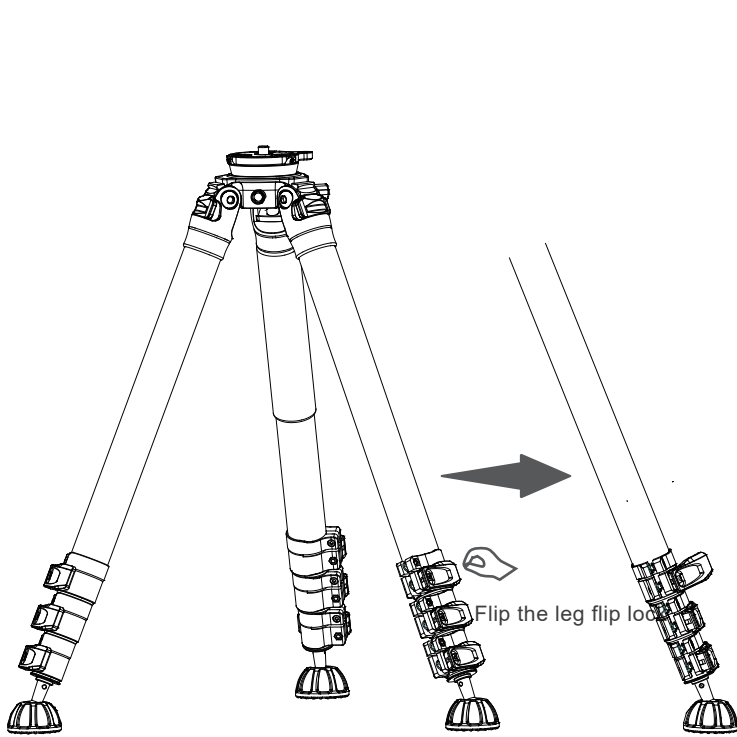

Install Foot Spike

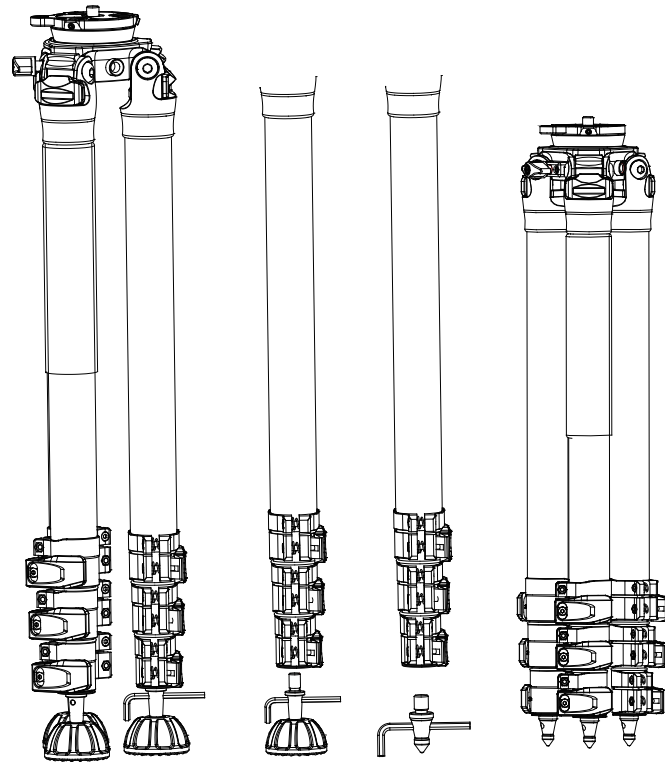

Warranty Card

Name :
Address:
Tel :
Email :
Item No. :
Serial No. :
Purchase date: YY MM DD
Notice: The warranty card is valid with the condition that the purchase date should be the same as the payment voucher date, and please carry the original warranty card or its copy for warranty.

Qualified Certificate

