

TRIPOD USER'S MANUAL

Model#:W-324D3C Kit

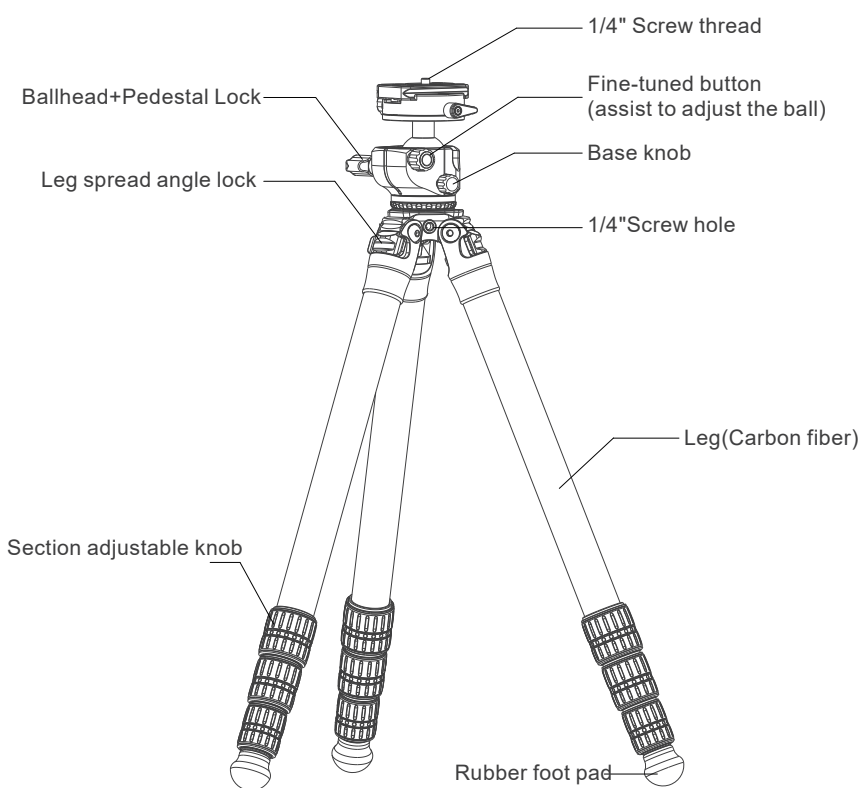

中山精格电子科技有限公司
ZHONGSHAN JINGGE ELECTRONIC TECHNOLOGY CO., LTD.

HEAD

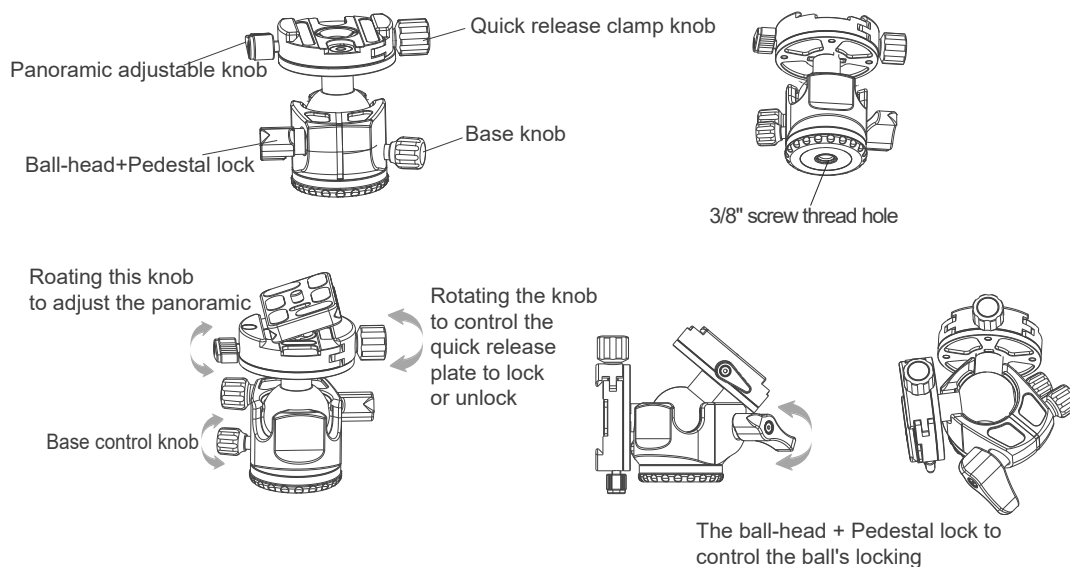

LEG ANGLE

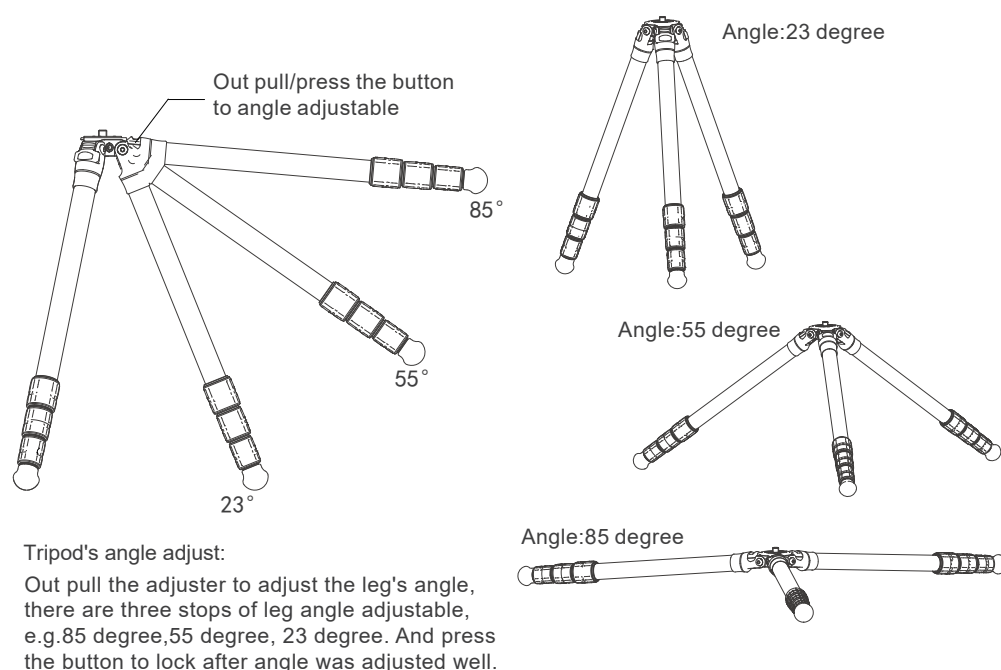

TRIPOD LEG EXTEND

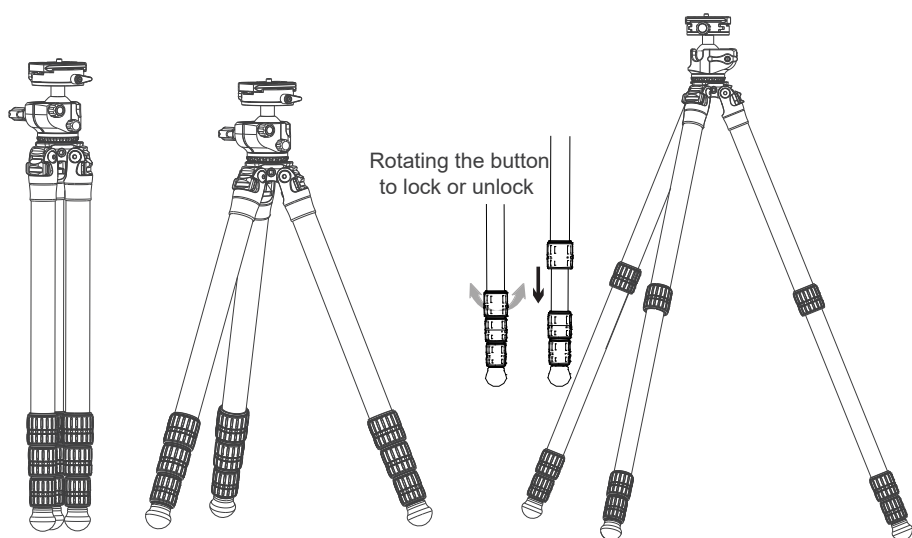

HEAD INSTALLING

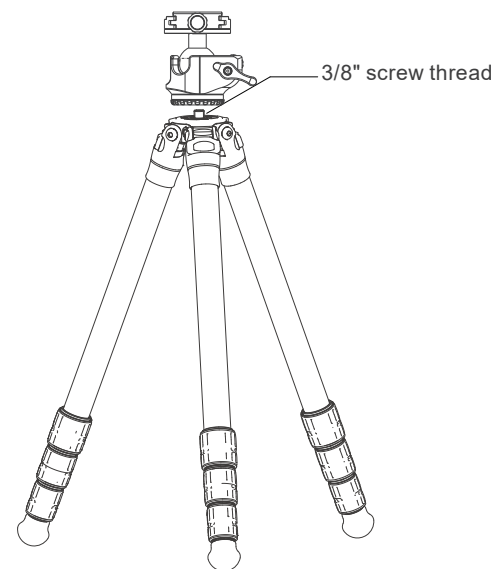

NOTICE

- 1.Do not exceed the large capacity of loading.
- 2.Make sure to lock and keep safe when operating the tripod.
- 3.The best working temperature is between Minus 40 degree - 100 degree, do please use it in the temperature range.Do not use the tripod at sea.
- 4.Do not keep the product under the sunshine for long time.
- 5.To make sure all equipments(like camera)was taken down from the tripod when on transportation.
6. After working, do keep it clean of all accessories and tripod before packing.
- 7.Do please use the standard lube(oil) if need.
- 8.Do not connect any power when using.

FOOT SPIKE INSTALLING

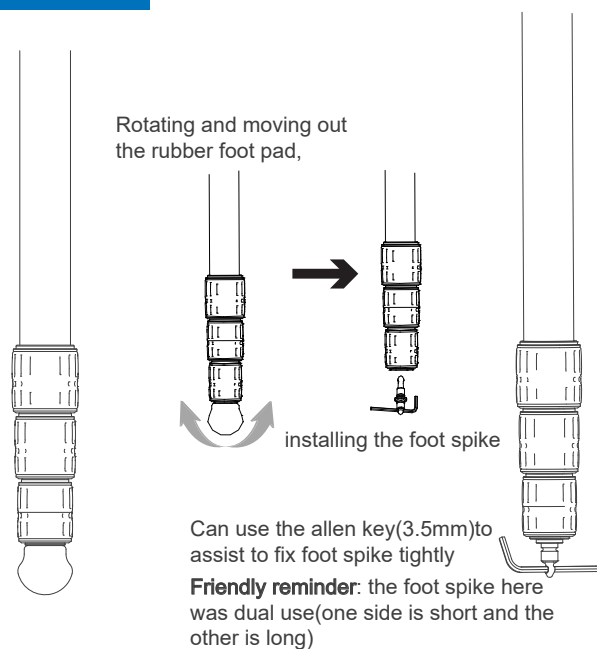

Friendly Tips

If you need to moving the tripod position on shooting, do please take down the camera(espacial for the telephoto lens),it may broke down your camera.